

362

AN ORDINANCE TO AMEND THE CORPORATE LIMITS OF THE CITY OF ROANOKE, ALABAMA BY INCLUDING IN THE CORPORATE LIMITS OF ROANOKE, ALABAMA CERTAIN PROPERTIES AT THE REQUEST OF THE OWNERS OF SAID PROPERTY AND TO REPEAL ALL ORDINANCES OR PARTS OF ORDINANCES IN CONFLICT HEREWITH.

BE IT ORDAINED BY THE CITY COUNCIL OF THE CITY OF ROANOKE, ALABAMA AS FOLLOWS:

Section 1. That the Corporate Limits of the City of Roanoke, Alabama be altered and changed to include within the Corporate Limits of the City of Roanoke, Alabama, the following described property situated in Randolph County Alabama, to-wit:

THE PROPERTY OF JOHN A. AND WIFE ROBIN S. WILLIAMS:

PARCEL # 1

Beginning at the NE Corner of the SW Quarter of the NE Quarter of Section 24, Township 21, Range 12, thence North $88^{\circ}30' 04''$ West a distance of 1,328.08 feet to the East right of way of a dirt Road. Thence South $4^{\circ}22' 03''$ West along the East right of way of dirt Road a distance of 264.51 feet to the Northwest corner of Macedonia Church lot. Thence South $87^{\circ}48' 20''$ East a distance to 210 feet, to the Northeast corner of said Church lot. Thence South $4^{\circ}22' 03''$ West a distance of 622.29 feet to the Southeast corner of said Church lot. Being of the North property line of Bruce Cottle's lot. Thence South $87^{\circ}48' 20''$ East a distance of 315 feet to the Northeast corner of Cottle's lot. Thence South $4^{\circ}22' 03''$ West a distance of 855 feet to a Creek bed in existing Lake. Thence North $52^{\circ}23' 46''$ East a distance of 679.12 feet, thence South $87^{\circ}48' 20''$ East a distance of 280 feet. Thence North $5^{\circ}06' 27''$ East a distance 1,323.68 feet to the point of beginning. The above containing 34.24 acres, situated in the SW $\frac{1}{4}$ of the NE $\frac{1}{4}$, the NW $\frac{1}{4}$ of the SE $\frac{1}{4}$ of Section 24, Township 21, Range 12 of Randolph County, Alabama.

PARCEL # 2

Beginning at the NE Corner of the SW Quarter of the NE Quarter of Section 24, Township 21, Range 12, Thence North $6^{\circ}45'$ West a distance of 1,292 feet to a point and corner. Thence South $89^{\circ}30'$ East a distance of 749.3 feet, to the West right of way of the Wedowee-Bacon Level Road. Thence South $10^{\circ}50'$ East a distance of 1,027.5 feet and South $4^{\circ}35'$ East a distance of 220.5 feet along the Westerly right of way of said Wedowee-Bacon Level Road. Thence North $89^{\circ}00'$ West a distance of 1,119.24 feet to the point of beginning. The above containing 27.24 acres. All the land in the NE $\frac{1}{4}$ of the NE $\frac{1}{4}$ of Section 24, Township 21, Range 12, that lies West of the Wedowee-Bacon level Road. Randolph County, Alabama.

PARCEL # 3

Beginning at a point of intersection where the West right of way line intersects the Northern Boundary line of the NE $\frac{1}{4}$ of the NE $\frac{1}{4}$ of Section 24, Township 21, Range 12, Thence run due West along said forty a distance of 166.0 feet to the middle of the creek. Thence run North 5 $^{\circ}$ 45' West along the centerline of the creek, a distance of 119.8 feet to a fence. Thence run North 89 $^{\circ}$ 00' East along an old fence, a distance of 156.0 feet, to the West right of way of the Wedowee-Bacon Level Road. Thence South 10 $^{\circ}$ 50' East, along the Westerly right of way of said Wedowee-Bacon Level Road a distance of 123.0 feet to the point of beginning. The above containing 0.45 acres and located in the SE $\frac{1}{4}$ of the SE $\frac{1}{4}$ Of Section 13, Township 21, Range 12, Randolph County, Alabama.

Section 2. From and after the date of the publication of this Ordinance the property described in Section 1 above shall be included in the Corporate Limits of the City of Roanoke, Alabama, pursuant to Article 2, Chapter 42, Title II, Code of Alabama 1975.

Section 3. All ordinances and parts of ordinances in conflict with this Ordinance are hereby repealed.

Section 4. This Ordinance shall be in force and effect upon its passage and adoption as provided by law.

adopted and approved this the _____ day of _____, 19____.

Henry V. Bonner, Mayor

ATTEST:

Olin E. Sheppard, City Clerk

AAE858

PETITION OF OWNER OF REAL PROPERTY TO BE INCLUDED IN THE CORPORATE LIMITS OF THE CITY OF ROANOKE, ALABAMA

STATE OF ALABAMA)

:

RANDOLPH COUNTY)

Comes John A. and Wife Robin S. and files this written petition to have certain real properties owned by them annexed and included in the Corporate Limits of the City of Roanoke, Alabama, pursuant to Article 2, Chapter 42, Title II, Code of Alabama 1975.

1. Descriptions of the petitioners' real estate within an area of Randolph County, Alabama and contiguous to the Corporate Limits of the City of Roanoke, Alabama, an incorporated municipality with a population of 2,000 inhabitants or more, which property does not lie within the Corporate Limits or police jurisdiction of any other municipality, are as follows:

THE PROPERTY OF JOHN A. AND WIFE ROBIN S. WILLIAMS

PARCEL # 1

Beginning at the NE Corner of the SW Quarter of the NE Quarter of Section 24, Township 21, Range 12, thence North 88°30' 04" West a distance of 1,328.08 feet to the East right of way of a dirt Road. Thence South 4°22' 03" West along the East right of way of dirt Road a distance of 264.51 feet to the Northwest corner of Macedonia Church lot. Thence South 87°48' 20" East a distance of 210 feet, to the Northeast corner of said Church lot. Thence South 4°22' 03" West a distance of 622.29 feet to the Southeast corner of said Church lot. Being on the North property line of Bruce Cottle's lot. Thence South 87°48' 20" East a distance of 315 feet to the Northeast corner of Cottle's lot. Thence South 4°22' 03" West a distance of 855 feet to a Creek bed in existing Lake. Thence North 52°23' 46" East a distance of 679.12 feet, thence South 87°48' 20" East a distance of 280 feet. Thence North 5°06' 27" East a distance of 1,323.68 feet to the point of beginning. The above containing 34.24 acres, situated in the SW¼ of the NE¼, the NW¼ of the SE¼ of Section 24, Township 21, Range 12 of Randolph County Alabama.

PARCEL # 2

Beginning at the NE Corner of the SW Quarter of the NE quarter of Section 24, Township 21, Range 12, Thence North 6°45' West a distance of 1,292 feet to a point and corner. Thence South 89°30' East a distance of 749.3 feet to the West right of way of the Wedowee-Bacon level Road. Thence South 10°50' East a distance of 1,027.5 feet and South 4°35' East a distance to 220.5 feet along the Westerly right of way of said Wedowee-Bacon level Road. Thence North 89°00' West a distance of 1,119.24 feet to the point of beginning. The above containing 27.24 acres, . All the land in the NE¼ of the NE¼ of Section 24, Township 21, Range 12, that lies West of the Wedowee-Bacon Level Road, Randolph County, Alabama.

PARCEL # 3

Beginning at a point of intersection where the West right of way line intersects the Northern Boundary line of the NE¼ of the NE¼ of Section 24, Township 21, Range 12, Thence run due West along said forty a distance of 166.0 feet to the middle of the creek. Thence run North 5°45' West, along the centerline of the creek, a distance of 119.8 feet to a fence. Thence run North 89°00' East along an old fence, a distance of 156.0 feet, to the west right of way of the Wedowee-Bacon Level Road. Thence South 10°50' East, along the Westerly right of way of said Wedowee-Bacon Level Road a distance of 123.0 feet to the point of beginning. The above containing 0.45 acres and located in the SE¼ of the SE¼ of Section 13, Township 21, Range 12, Randolph County, Alabama

2. There is attached hereto and made a part hereof a map of the above described properties to be annexed showing their relationship to the Corporate Limits of the City of Roanoke, Alabama.

Wherefore, petitioners request that the City Council or the City of Roanoke, Alabama adopt an ordinance assenting to the annexation of said properties to such municipality to the end that the Corporate Limits of such municipality shall be extended and rearranged so as to embrace and include such properties within the corporate area of such municipality upon the date of publication of said ordinance.

In Witness Whereof, we sign our names this 8TH day of FEBRUARY, 1988

JOHN ALAN WILLIAMS

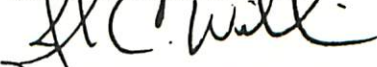

ROBIN SPAIN WILLIAMS



AAE858

AREA IN RED TO BE ANNEXED

RIVISIONS:
CITY LIMITS-1 OCT.1981

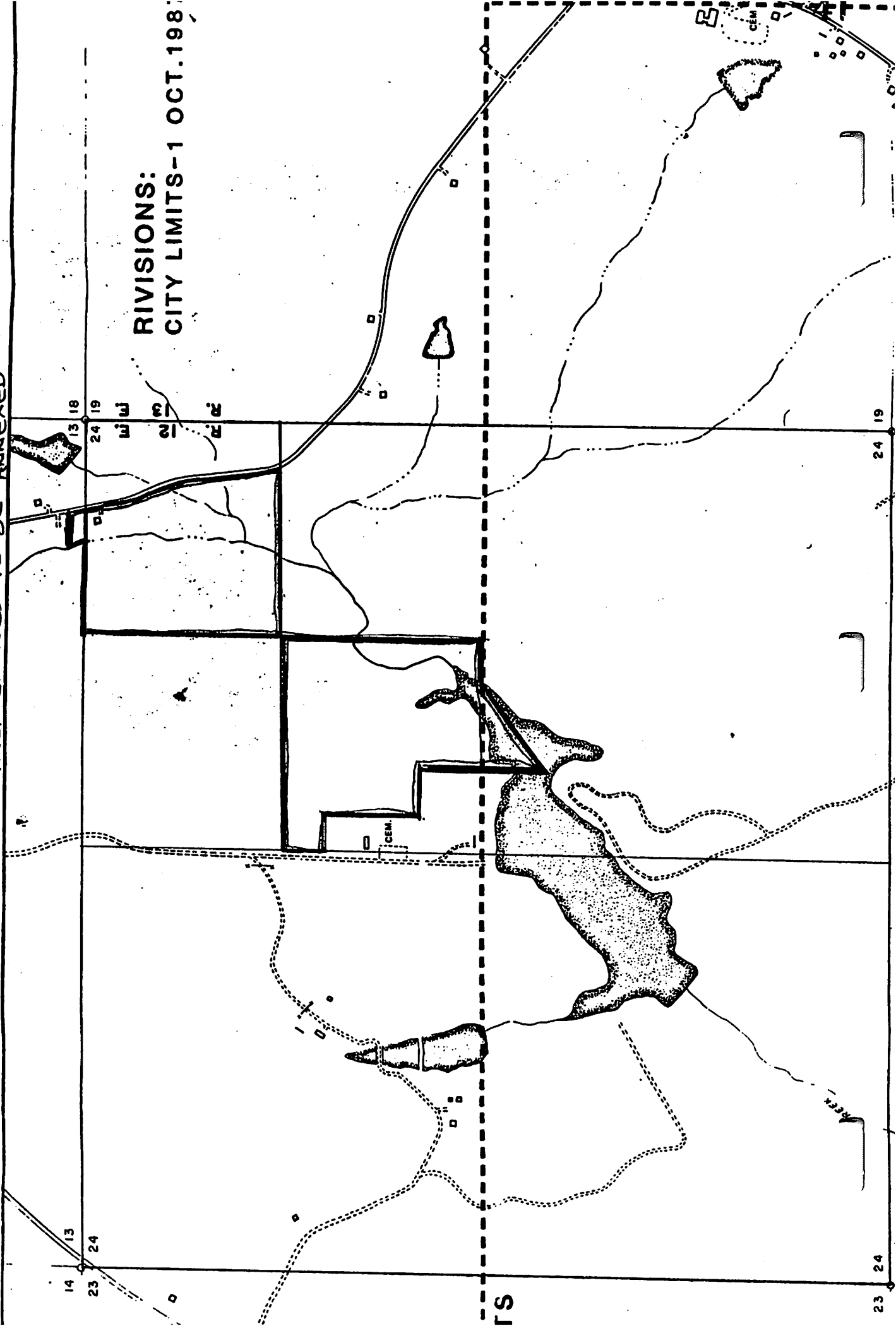

TS

CERTIFICATION

I, Olin E. Sheppard, as the City Clerk of the City of Roanoke, Alabama, hereby certify that the foregoing Ordinance No. 641, was ~~passed and adopted by the Mayor and City Council for the City of~~ Roanoke, Alabama on the 8th day of February, 1988, and was herein recorded.

Olin E. Sheppard, City Clerk

AN ORDINANCE

NO. 642

BE IT ORDAINED BY THE CITY COUNCIL OF THE CITY OF ROANOKE, ALABAMA AS FOLLOWS:

Section 1. That the salary of the mayor of the City of Roanoke, Alabama, shall be and the same is hereby fixed at the sum of \$ 500.00 per month.

Section 2. That each councilmember shall be compensated at the sum of \$ 100.00 per month.

Section 3. This ordinance shall become effective on the first Monday in October, 1988, and shall continue in force and effect until repealed by action of the council.

ADOPTED AND APPROVED THIS THE 22nd DAY OF February, 1988.

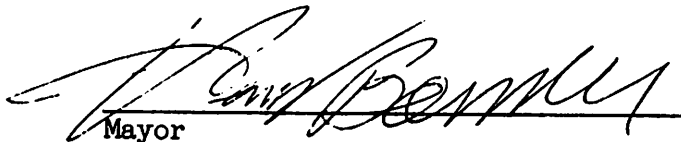

Mayor

ATTEST:



City Clerk

AAE858

CERTIFICATION

I, Olin E. Sheppard, as the City Clerk of the City of Roanoke, Alabama, hereby certify that the foregoing Ordinance No. 642, was passed and adopted by the Mayor and City Council for the City of Roanoke, Alabama on the 22nd day of February, 1988, and was herein recorded and was published in the Randolph Leader of general circulation in the City of Roanoke, Alabama, on the 24th day of February, 1988.

Olin E. Sheppard, City Clerk